



Eton Avenue NW3

Parkheath
Sold on Service



SPRINGFIELD COURT

P
SSE
1000

KP05 NCA

L668 LDF



Eton Avenue, NW3

Asking Price

£725,000, Leasehold - Share

Camden Band E

- Premier road in Belsize Park
- Good decorative order
- Popular purpose built block
- 2 double bedrooms
- Top floor (3rd) with lift
- 741 sq ft approx
- 19' reception with wood block flooring
- Contemporary kitchen with window
- 13' master bedroom with built-in wardrobes
- Share of freehold



Belsize Park
208 Haverstock Hill
NW3 2AG
Sales 020 7431 1234
Lettings 020 7431 3104
nw3@parkheath.com

South Hampstead
8a Canfield Gardens
NW6 3BS
Sales 020 7625 4567
Lettings 020 7644 0800
nw6@parkheath.com

West Hampstead
192 West End Lane
NW6 1SG
Sales & Lettings
Tel 020 7794 7111
192@parkheath.com

Kentish Town
148 Kentish Town Rd
NW1 9QB
Tel 020 7485 0400
kt@parkheath.com

Kensal Rise
54-56 Chamberlayne Rd
NW10 3JH
Tel 020 8960 4845
kensal@parkheath.com

Property Management
192 West End Lane
NW6 1SG
020 7433 6174
pm@parkheath.com

Parkheath
Sold on Service

Springfield Court, NW3
Approx. Gross Internal Area
741 Sq Ft - 68.84 Sq M

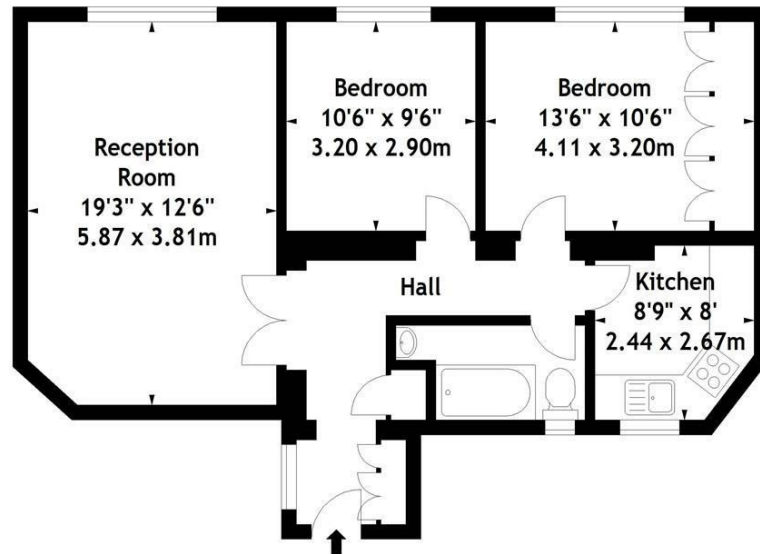

Third Floor

Measured in accordance with RICS guidelines. Every attempt is made to ensure accuracy, however all measurements are approximate. This floor plan is for illustrative purposes only and is not to scale.

© Datography Ltd 2014
Photographs * Floorplans * Virtual Tours
Tel: 0845 643 4401 www.datography.com

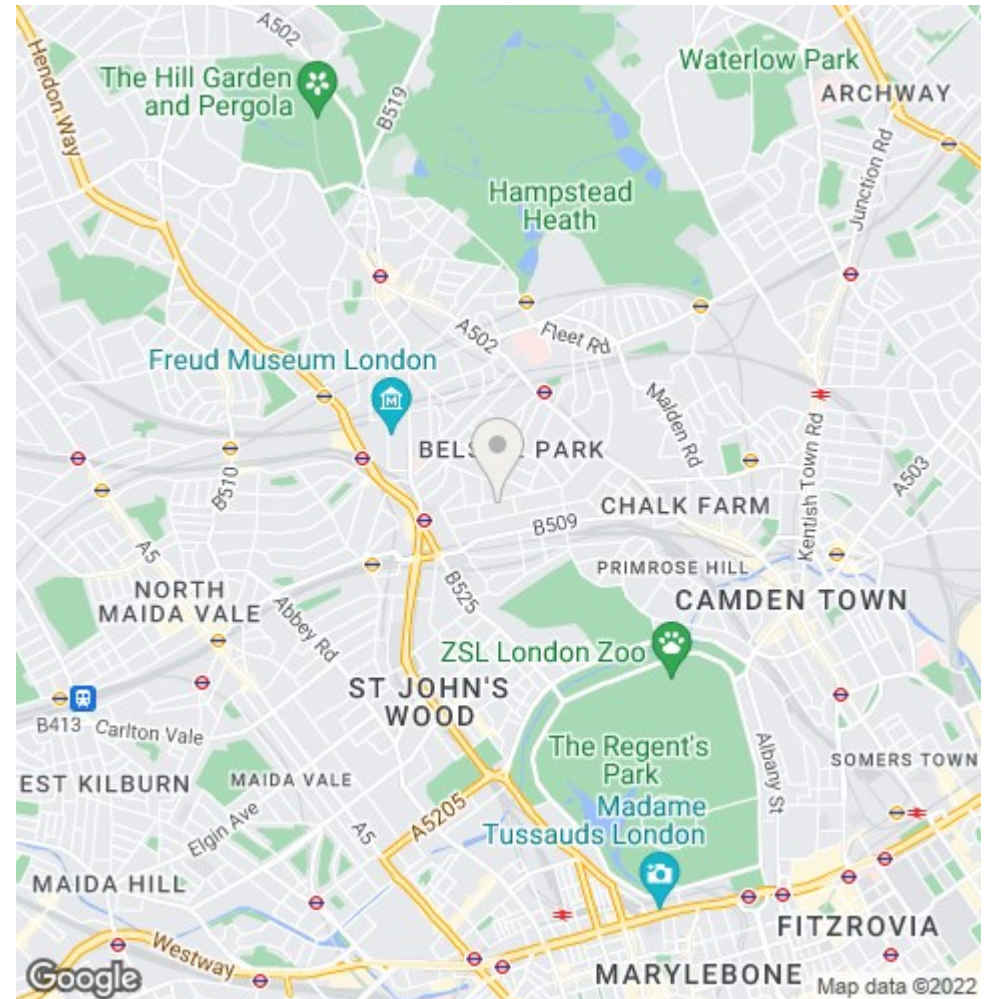

The particulars do not constitute part of an offer or contract. The particulars, including text, photographs and plans, are for the guidance only of prospective purchasers/tenants and must not be relied upon as statements of fact. The descriptions provided therein represent the opinion of the author and whilst given in good faith should not be construed as statements of fact. Nothing in these particulars shall be deemed a statement that the property is in good condition or otherwise or that any services or facilities are in good working order. All measurements are approximate